

GEYA



适用范围 Scope of application

家用交流接触器(以下简称接触器)主要适用于交流50Hz(或60Hz), 额定工作电压至250V/400V。额定工作电流至63A的电力系统中, 用于在AC-1、AC-7a、AC-7b使用类别下, 作远距离频繁接通和分断, 控制家用电器和类似用途的无感低感微感负载的控制电路用;也可用来控制家用电动机负载,此时控制功率要相应降低。

接触器不可用于分断短路电流, 因此使用时应选配适当的短路保护电器。

产品应用于家庭、宾馆、公寓、办公楼、医院、公共建筑、超市、城市照明、汽车充电桩等场所, 从配电箱到开关柜用于照明、供暖、通风、卷帘门窗、空调、家用水泵实现自动化功能, 也应用于大多日常使用的家用电器产品中。

标准: GB/T17885 IEC/EN61095

Household AC contactors (hereinafter referred to as connectors) are mainly used for AC 50Hz (or 60Hz), rated working voltage to 250V/400V. In power systems with rated operating current up to 63A, used for long-distance frequent switching on and off under AC-1, AC-7A, AC-7B usage categories, a control circuit used to control a low-inductance, low-inductance, micro-inductance load on household appliances and similar applications; also used to control a household motor load, at which point the control power must be reduced accordingly.

Contactors can not be used to break short-circuit current, so use should be equipped with appropriate short-circuit protection electrical appliances.

Products used in homes, hotels, apartments, office buildings, hospitals, public buildings, supermarkets, urban lighting, car charging piles and other places, from distribution box to switch cabinet for lighting, heating, ventilation, shutter doors and windows, air conditioning, home pumps to achieve automation, but also used in most of the daily use of household appliances products.

Standard: GB/T17885 IEC/EN61095

正常工作条件和安装条件 Normal working and installation conditions

周围空气温度 Ambient air temperature	温度不高于+60℃, 不低于-5℃, 当产品安装在配电箱内时, 其两侧必须拼装隔热件, 以利于散热。 The temperature shall not be higher than +60℃ or lower than -5℃. When the product is installed in the power distribution box, thermal insulation parts must be assembled on both sides to facilitate heat dissipation.
海拔高度 Altitude	不超过2000米 Not exceeding 2000m
大气条件 Atmospheric conditions	安装地点的空气相对湿度在最高温度为+40℃时不超过50%; 在较低的温度下允许有较高相对湿度, 例如+20℃时达90%, 对于温度变化偶尔产生的凝露应采取特殊的措施。 The relative humidity of the air at the installation site shall not exceed 50% when the maximum temperature is +40℃; Higher relative humidity is allowed at lower temperature, such as 90% at +20℃. And special measures shall be taken for occasional condensation due to temperature changes.
污染等级 Atmospheric condition pollution level	2级 Level 2
安装类别 Installation category	II级 Level II
冲击振动 Shock vibration	安装处应无显著冲击和振动 There shall be no significant shock and vibration at the installation position
安装方式 Installation mode	采用TH35-7.5型钢安装轨安装 TH35-7.5 profile steel mounting rail is used for installation
安装条件 Installation conditions	安装位置应垂直, 各方向的倾斜度不超过±5° The installation position shall be vertical, and the inclination in each direction shall not exceed ±5°
防护等级 Degree of protection	IP20
动作条件 Action conditions	吸合电压 (85%~110%) Us; 释放电压为 (20%~75%) Us Pull in voltage under operating conditions (85% ~ 110%) Us; The release voltage is (20% ~ 75%) Us.

低噪音 low noise

产品全新设计, 80%生产过程采用自动化, 全程关键工序自动化监控, 从设计和制程上消除传统接触器在工作上遇到的噪音问题。

New product design, 80% of the production process is automated, automatic monitoring of the whole key processes, from the design and process to eliminate the noise problems encountered in the work of traditional contactors.

超长寿命 Ultra-long life

银合金触点, 优化的电磁系统, 稳定可靠, 超长寿命

Silver alloy contacts, optimized electromagnetic system, stable and reliable, long life

导轨安装设计 Rail mounting design

采用直动式倒装结构可与小型断路器组合装在控制照明箱内

The direct moving flip structure can be combined with small circuit breaker in the control lighting box

体积小: 模数化设计 Compact size: modular design

接触器的额定电流、控制电压、吸合保持功率

Rated current, control voltage and holding power of contactor



类型 Type	额定电流(In) Rated current (In)		控制电压 Control voltage (V AC)(50 Hz)	功耗 Consumption		最大功率 Maximum power
	AC-7a	AC-7b		保持 Holding	吸合 Inrush	
2P	16A	6A	12	3.8VA	15VA	1.3W
			24	3.8VA	15VA	1.3W
			110	3.8VA	15VA	1.3W
			220...240	2.7VA	9.2VA	1.3W
	20A	7A	12	3.8VA	15VA	1.3W
			24	3.8VA	15VA	1.3W
			110	3.8VA	15VA	1.3W
			220...240	2.7VA	9.2VA	1.2W
	25A	8.5A	12	3.8VA	15VA	1.3W
			24	3.8VA	15VA	1.3W
			110	3.8VA	15VA	1.3W
			220...240	2.7VA	9.2VA	1.2W
	32A	12A	110	4.6VA	34VA	1.6W
			220...240	4.6VA	34VA	1.6W
	40A	15A	110	4.6VA	34VA	1.6W
			220...240	4.6VA	34VA	1.6W
63A	20A	110	4.6VA	34VA	1.6W	
		220...240	4.6VA	34VA	1.6W	
4P	16A	6A	24	4.6VA	34VA	1.6W
			110	4.6VA	34VA	1.6W
			220...240	4.6VA	34VA	1.6W
	20A	7A	24	4.6VA	34VA	1.6W
			110	4.6VA	34VA	1.6W
			220...240	4.6VA	34VA	1.6W
	25A	8.5A	24	4.6VA	34VA	1.6W
			110	4.6VA	34VA	1.6W
			220...240	4.6VA	34VA	1.6W
	32A	15A	24	6.5VA	53VA	2.1W
			110	6.5VA	53VA	2.1W
			220...240	6.5VA	53VA	2.1W
	40A	15A	24	6.5VA	53VA	2.1W
			110	6.5VA	53VA	2.1W
			220...240	6.5VA	53VA	2.1W
	63A	20A	24	6.5VA	53VA	2.1W
			110	6.5VA	53VA	2.1W
			220...240	6.5VA	53VA	2.1W

操作(手动控制接触器) Operation(Manual control contactor)

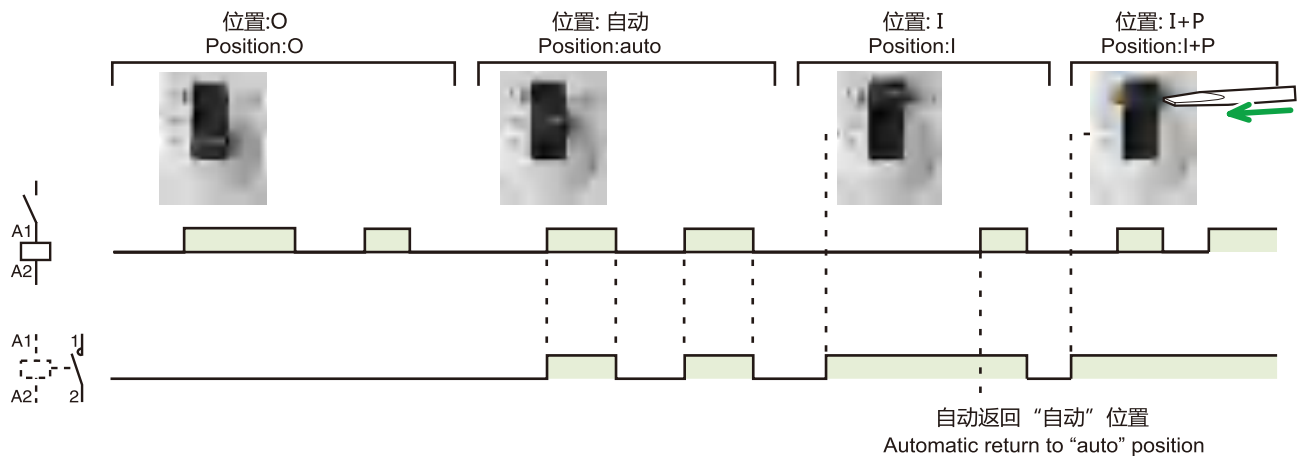

款式与选型 Style and selection

●辅助触头O+F :
auxiliary contact

16A 20A 25A
1P/2P



16A 20A 25A
3P/4P



32A 40A 63A
1P/2P



32A 40A 63A
3P/4P



极数 number of poles	宽度 (mm) breadth (mm)	额定电流 In (A) Rated current In (A)	额定控制电源电压 Us (V) Rated power supply voltage Us (V)	触点 contact
1P	18	16A/20A/25A	AC24V AC110V AC230V	1NO、1NC
2P	18	16A/20A/25A	AC24V AC110V AC230V	2NO、2NC、1NO1NC
3P	36	32A/40A/63A	AC24V AC110V AC230V	3NO、3NC
4P	54	32A/40A/63A	AC24V AC110V AC230V	4NO、4NC、2NO2NC、3NO1NC

附件安装 Accessories installing

The new heat insulation is easy to install, saves space and has better heat dissipation effect

新款隔热件安装方便，节省空间，散热效果更好

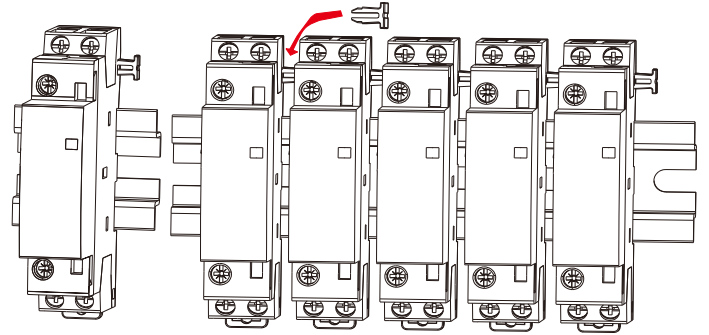
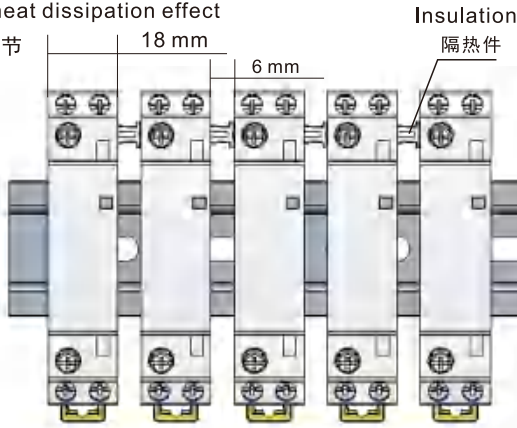

注：2P产品在安装过紧（密）时，产品间必须安装隔热件，以利于散热；当配电箱内温度过高时，接触器需要降容使用。

隔热件安装

Insulation installation

Note: When 2P products are installed too tightly, heat insulation parts must be installed between products to facilitate heat dissipation; When the temperature in the distribution box is too high, the capacity of contactor needs to be reduced.

外形及安装尺寸 Outline and installation dimensions

16A-25A/1P 2P

16A-25A 3P/4P

32A-63A 1P/2P

32A-63A 3P/4P

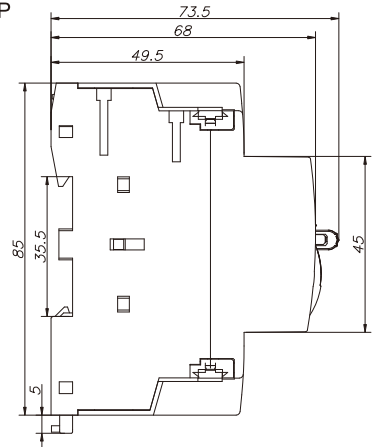
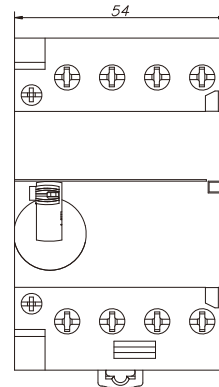
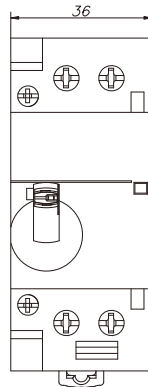
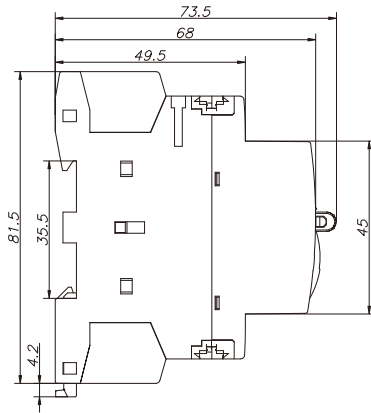
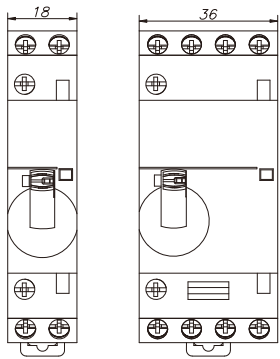

16A-25A/1P 2P 16A-25A 3P/4P

32A-63A 2P

32A-63A 4P

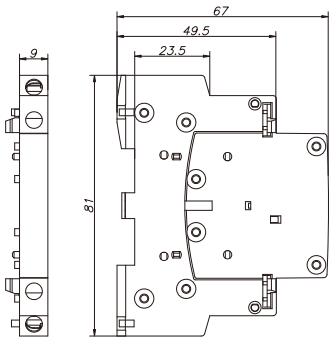

O+F



汽车充电桩
Automobile Charging Pile



照明控制系统
Lighting Control System



商用电热开水器
Commercial Electric Boiler



全自动绕线检测生产线

Automatic Winding Inspection Production Line

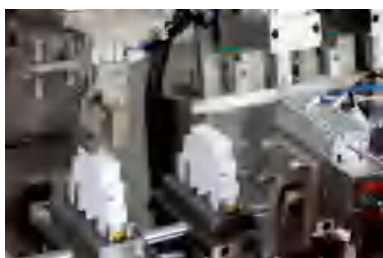
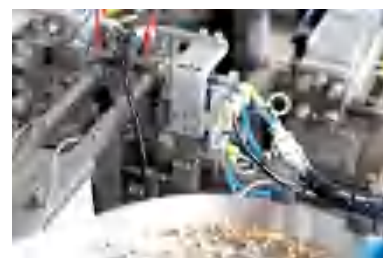

全自动装配测试生产线

Automatic Assembly Test Line

